

FAUX CEILING

Installation Manual

Rev. 1.0 – 03.2009

pag. 1/8

INDEX

1. MATERIAL.....	2
2. INSTALLATION PROCEDURE	3
2.1. Pre-Drill Aluminum Channel	3
2.2. Assembling channels & fabric	3
2.3. Mobile gutter	7

1. MATERIAL

The material necessary for proper installation:

- Dual channel profile (cod. Corradi 02383).
- Single Channel profile (used only for mobile gutter application) (cod. Corradi 00113).
- Endcaps (cod. Corradi 02427).
- Fabric panels.
- Self-tapping screws INOX 2,9 x 9,5 (cod. Corradi 03049).
- Torx screws INOX TSP TORX 4 x 60 (cod. Corradi 02418).
- Rivets AFTC UNI9002 TT 3. 9x9B (cod. Corradi 00432)

2. INSTALLATION PROCEDURE

2.1. Pre-drill aluminum channel



Pre-drill the aluminum profile and ensure to countersink the back side as to avoid scratching the channels and fabric tubes.

2.2. Assembly of aluminum profile and fabric panels.



Position the double channel profile underneath the fabric tubes and ensure that the aluminum profile is perfectly flush with the aluminum fabric tubes NOT extending over ANY plastic caps. Attach the profile using the self-tapping screws.



Slip the rubber profile attached to the fabric panels into the grooves ensuring that you insert both rubber splines of each fabric panel at the same time.



Proceed to the next panel and repeat the process.



After having inserted the fabric panels, stretch them using the long screws and drive those inside the rubber spline until fabric is appropriately taut. (The spline is to be cut flush with the fabric after it has been fully inserted in the channels.)



After the screws have been installed, put the plastic end-caps on the ends of the profiles.



Drill an 8mm hole in the terminal tube end-cap in line with the bottom channel in the profile.



Break off any plastic that would hinder the insertion of the final fabric panel.

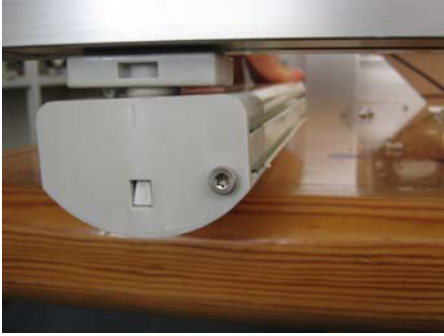

Using the long stainless screw, drive it into the rubber channel.



Ensure that the fabric panel is properly taut by tightening the screw.

2.3. Mobile gutter



Pre-drill the mobile gutter with a 4mm drill bit to then be fixed to the single channel aluminum profile with rivets.

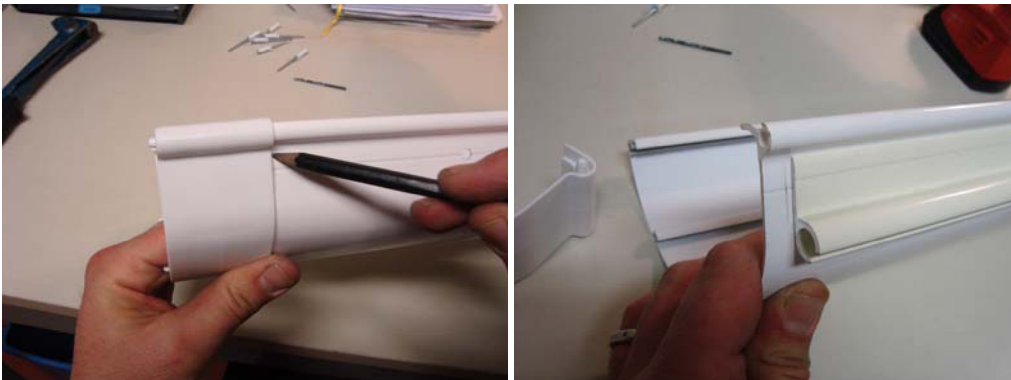

Place the single channel aluminum profile in a way that you can accurately mark the hole pattern previously drilled on the gutter.



Pre-drill the single channel aluminum profile with 4mm drill bit and countersink the holes.



Drill the same holes into the terminal tube to ensure that the river goes through the aluminum profile, the gutter, and the terminal tube.

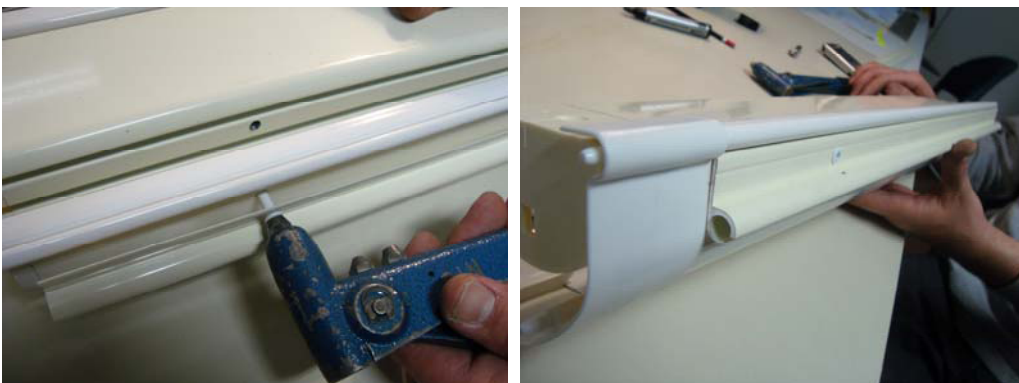

Attach the pieces together using rivets.