



Corradi

OUTDOOR LIVING SPACE

ALBA

Control box
Installation Manual | EN

rev. 0 / 10.2015

Index

<u>Installation guide (NL1282-1M1C-REN)</u>	<u>3</u>	<u>Lineo® LED control</u>	<u>7</u>
<u>Mounting</u>	<u>4</u>	<u>Lineo® LED Hardware</u>	<u>8</u>
<u>Cable entries</u>	<u>4</u>	<u>Lineo® LED Set-up</u>	<u>11</u>
<u>Wiring</u>	<u>5</u>	<u>Lineo® LED Memory Reset</u>	<u>17</u>
<u>Wiring description</u>	<u>5</u>		
<u>Extension linking</u>	<u>5</u>		
<u>Setting: Initial Installation of trasmitter</u>	<u>6</u>		
<u>Setting: Actuators Advanced Settings</u>	<u>6</u>		
<u>Setting: Factory Settings</u>	<u>6</u>		



INSTALLATION GUIDE

(NL1282-1M1C-REN)

Mounting:

Size and mounting holes (centimeters)

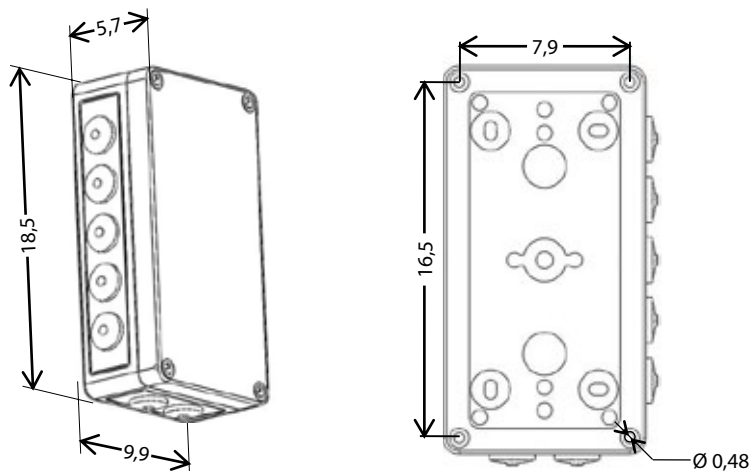

Cable entries:

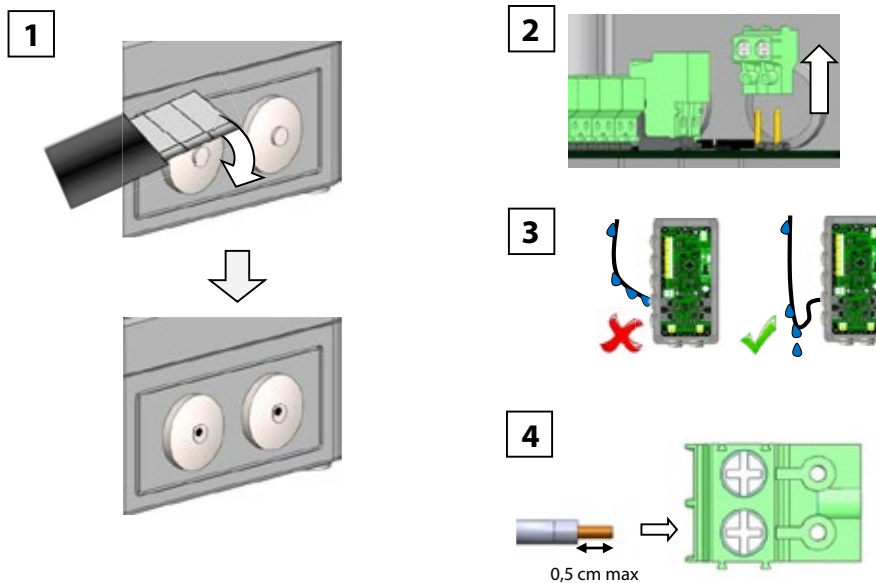

1. Cut the membrane of the gland
2. Remove the connectors for wiring
3. Insert the cables. Pay attention to cables (see drawing) to prevent water infiltration. Do not insert more than one cable per gland.
4. Bare wires (maximum 0,5 cm) and tighten the wire into the connectors. Respect section "Wiring" for cable connections.



Warning : It is imperative to work power off during the steps of mounting and wiring. Cable length must not exceed 30 meters.

Wiring:

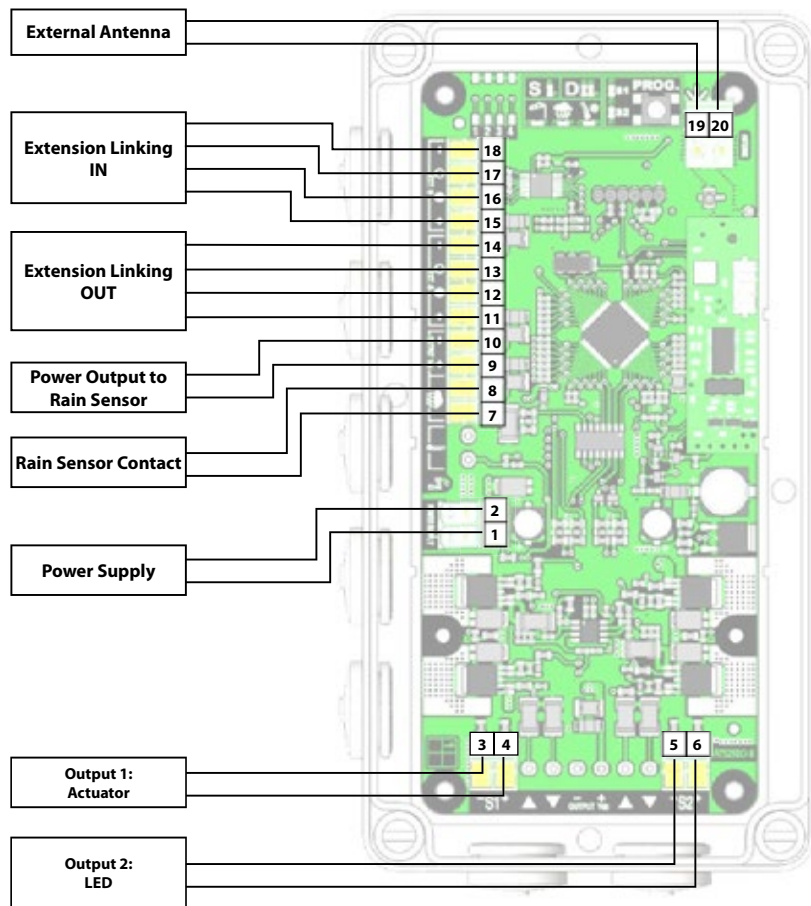

Wiring description:

POWER SUPPLY		
1	+	Input Power Supply: 24Vdc
2	-	
OUTPUT 1		
3	+	Actuator: 24Vdc – 6A max.
4	-	
OUTPUT 2		
5	+	Actuator: 24Vdc – 4.2A max. Light: PWM 24 Vdc – 4A max. Dry Contact: 60 Vac/dc – 500mA
6	-	
RAIN SENSOR		
7	Contact	Dry Contact Input
8	Common	
9	+	Power Output: 24Vdc – 300mA max.
10	-	
EXTENSION LINKING OUT		
11	+	Power Output 24Vdc – 300mA max.
12	DATA 1	TX
13	DATA 2	RX
14	-	Power Output 24Vdc – 300mA max.
EXTENSION LINKING IN		
15	+	Power Output 24Vdc – 300mA max.
16	DATA 1	RX
17	DATA 2	TX
18	-	Power Output 24Vdc – 300mA max.
EXTENSION ANTENNA (optional)		
19	SIGNAL	Core
20	GND	Braid Shield

Extension linking

Connection between Master and extension cards:
Connect the wire on the Extension OUT of the master card and on the Extension IN of the first extension.

Connection between extension:
Connect the wire on the Extension OUT of the first extension and on the Extension IN of the second extension.

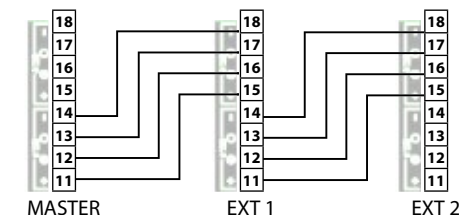

Available on reference:
NL1282-1M1C-REN

Setting:

Initial installation of transmitter

1. Press the PROG button on the electronic board for more than 2 seconds, until the S1 LED blinks, then release.
(Feedback on the S1 output, see "Glossaries" on the USE GUIDE)
2. Briefly press the PROG button on the electronic board to select the desired output S1 or S2. If the electronic card has only one output, proceed to the next step.
(Feedback on the selected output)
 - ➔ S1: Actuator output
 - ➔ S2: LED output
3. On Telis 4 or 16, select the desired channel.
4. Briefly press the Prog button on the back of the remote control.
(Feedback on the selected output)

Same procedure to save or delete a RTS sensor.

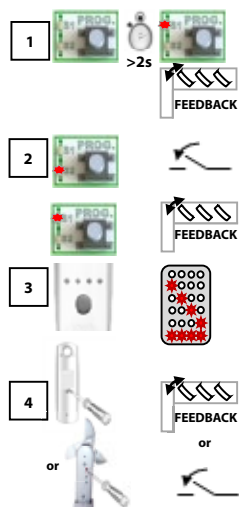

Factory Settings:

Complete erasure of memory:
Press the PROG button on the electronic board for more than 7 seconds until all the LED on the system board turn on.



Actuators Advanced Settings:

1. Press the PROG button on the electronic board for more than 2 seconds, until the S1 LED blinks, then release.
(Feedback on the S1 output)
2. Select the desired output. If the electronic card has only one output, proceed to the next step.
(Feedback on the selected output)
3. On Telis 4 or 16, select the desired channel.
4. Press simultaneously ⬆ + ⬇
(Feedback on the selected output)
5. Check direction:
 - ⬆ = Open
 - ⬇ = Close

If this is not the case, invert the direction by pressing ⏸ for more than 5 seconds.
(Feedback on the selected output)
Recheck the direction.
6. Open the pergola (press and hold ⬆)
7. Confirm the opened position by pressing simultaneously ⬇ + ⏸
(The pergola closes automatically.)
8. Stop movement by pressing ⏸
9. Close the pergola (press and hold ⬇)
10. Confirm the closed position by pressing simultaneously ⬆ + ⏸
(The pergola opens automatically)
11. Stop movement by pressing ⏸
12. Open the pergola to the position desired in case of snow (press and hold ⬆ or ⬇)
13. Confirm the snow position by pressing ⏸ for more than 2 seconds.
(Feedback on the selected output)
14. Briefly press the PROG button on the back of the remote control.

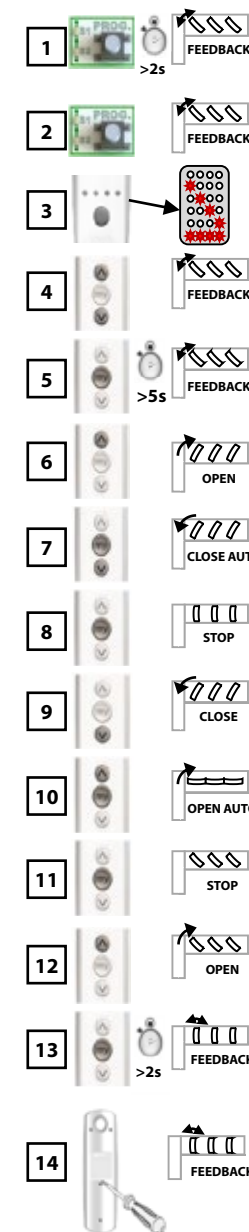

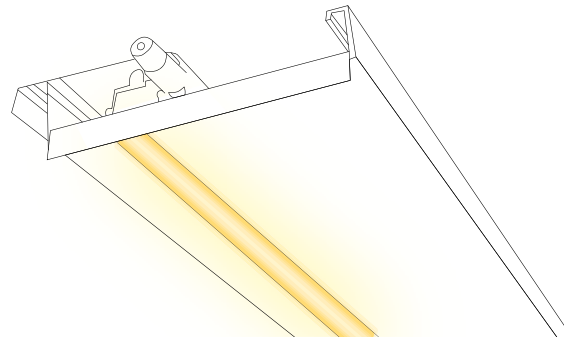

LINEO[®] LED CONTROL

Lineo® LED – Hardware

POWER SUPPLY		
1	+	Input Power Supply: 24Vdc
2	-	
OUTPUT 1		
3	-	PWM 24Vdc – 4.2A max.
4	+	
OUTPUT 2		
5	-	PWM 24Vdc – 4.2A max.
6	+	
OUTPUT 3		
5	-	PWM 24Vdc – 4.2A max.
6	+	
OUTPUT 4		
5	+	PWM 24Vdc – 4.2A max.
6	-	
RGB OUTPUT		
5	- Blue	PWM – 4.2A max.
7	- Red	PWM – 4.2A max.
9	- Green	PWM – 4.2A max.
10	+ Common	24Vdc – 12.6A max.
EXTENSION LINKING OUT		
11	+	Power Output: 24Vdc – 300mA max.
12	DATA 1	TX
13	DATA 2	RX
14	-	Power Output: 24Vdc – 300mA max.
EXTENSION LINKING IN		
15	+	Power Output: 24Vdc – 300mA max.
16	DATA 1	RX
17	DATA 2	TX
18	-	Power Output: 24Vdc – 300mA max.

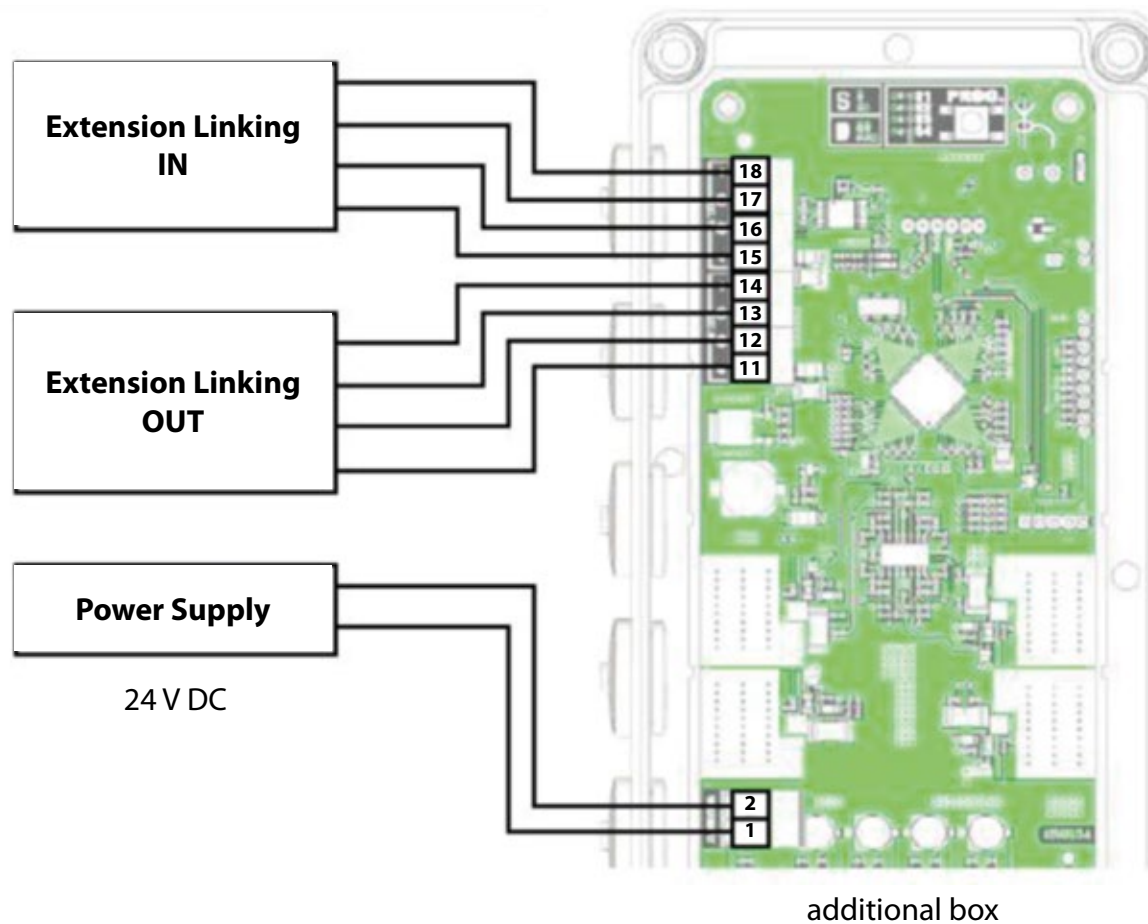

Lineo® LED – Hardware

**4 MONOCHROMES OUTPUTS
MODE**

additional box

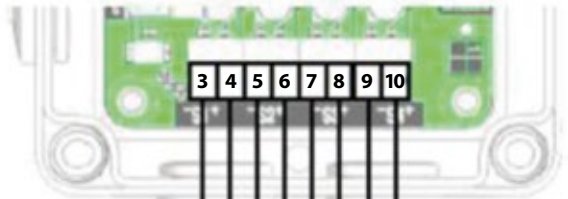

max.:

100 W

100 W

100 W

100 W

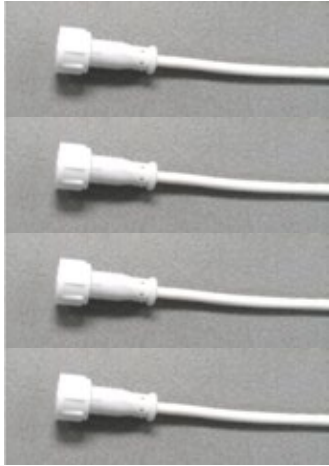

- Output 1:
Light
- Output 2:
Light
- Output 3:
Light
- Output 4:
Light

max.:

100 W

300 W

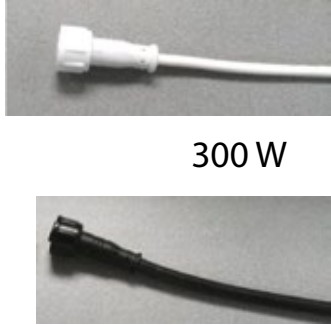

- Output 1:
Light
- Output RGB:
- Cathode Blue
- Cathode Red
- Cathode Green
- Common Anode

**1 MONOCHROME OUTPUT
+ 1 RGB OUTPUT MODE**

additional box

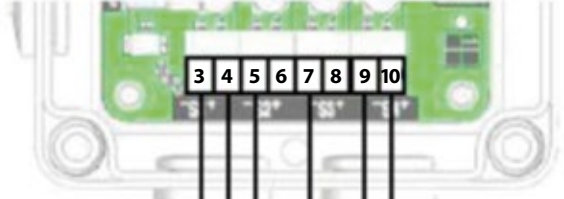

- Output 1:
Light
- Output RGB:
- Cathode Blue
- Cathode Red
- Cathode Green
- Common Anode

Lineo® LED – Hardware

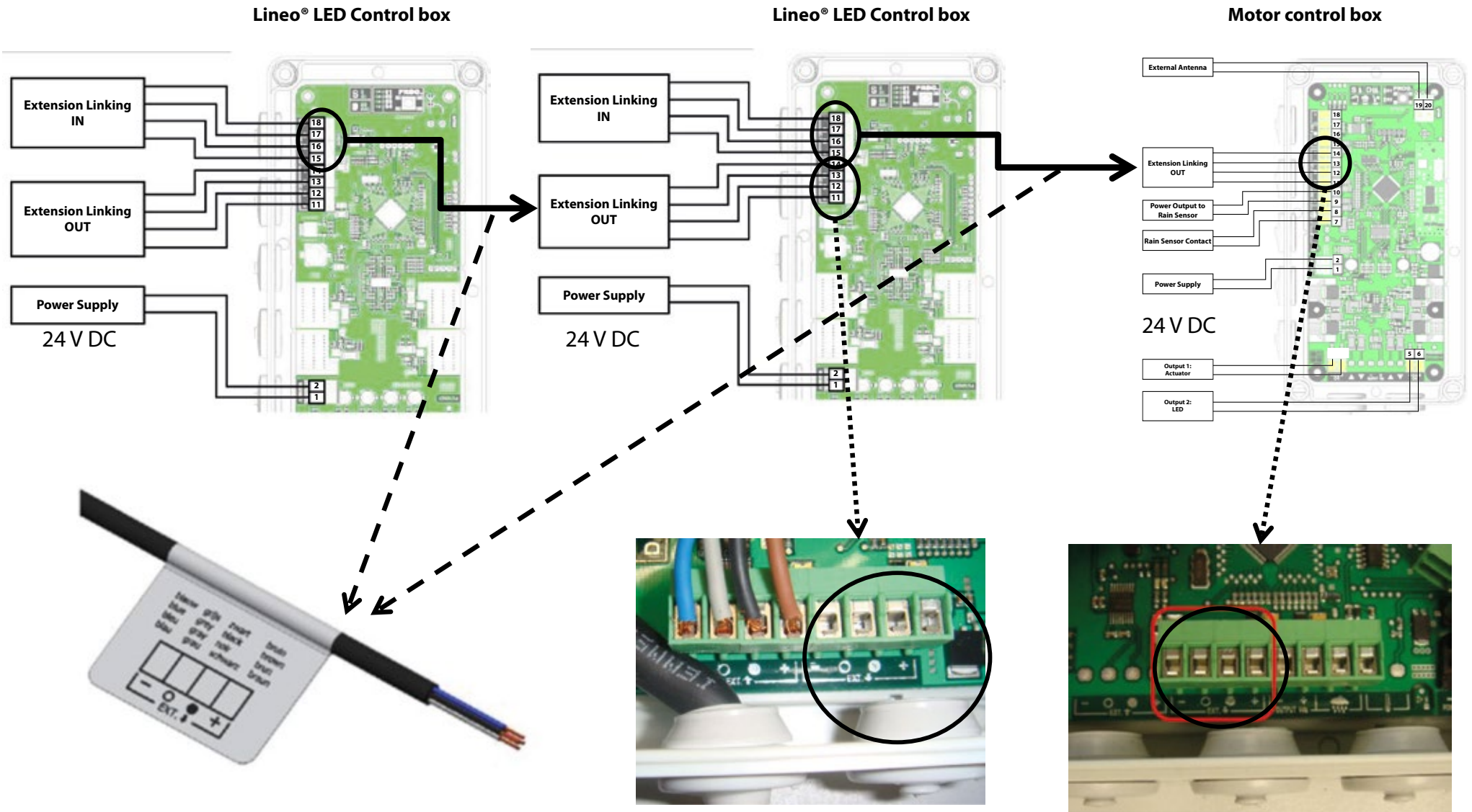

Lineo® LED – Set-up

White

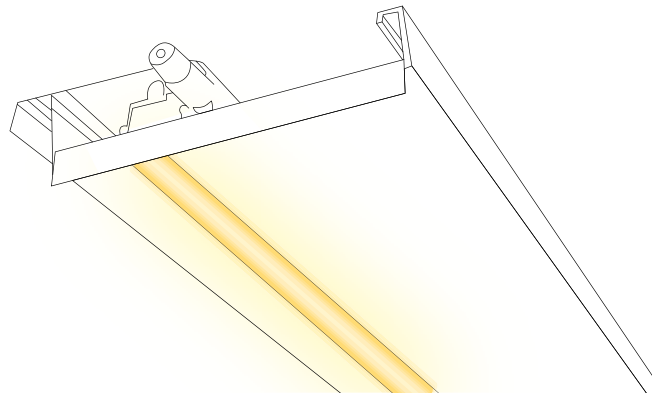
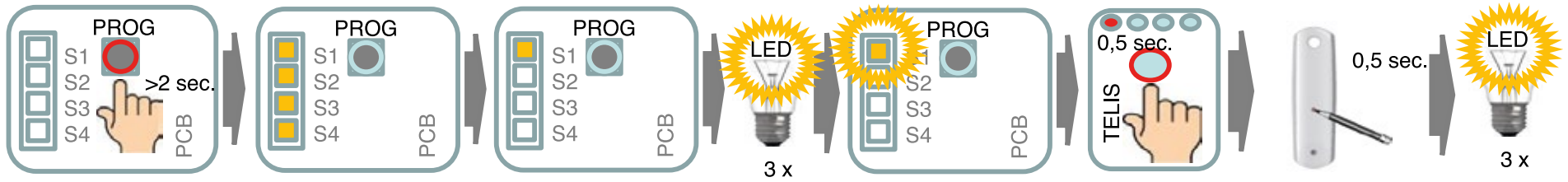
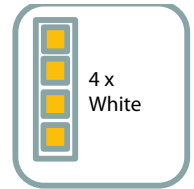

Lineo® LED – Set-up

White

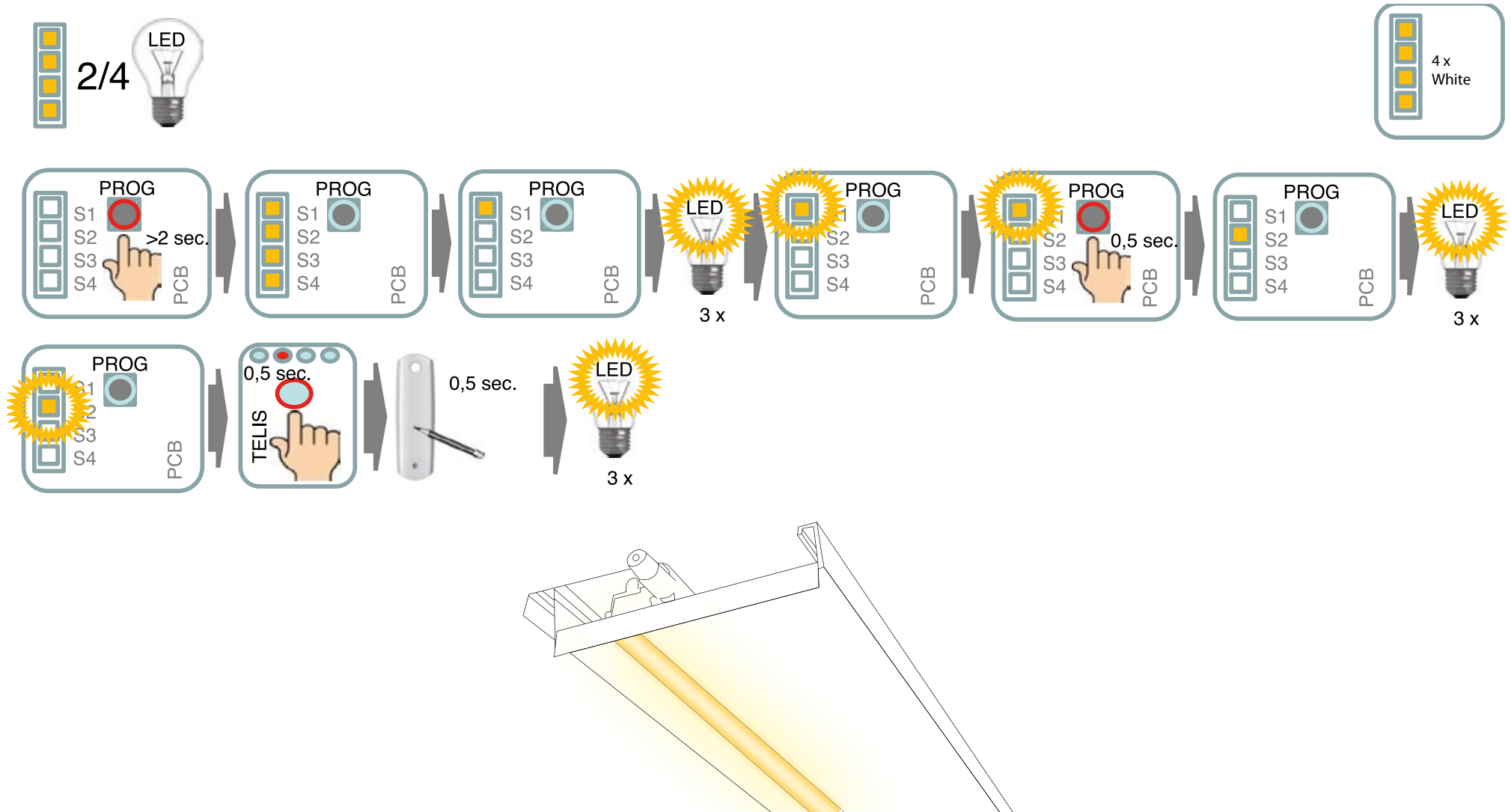

Lineo® LED – Set-up

White

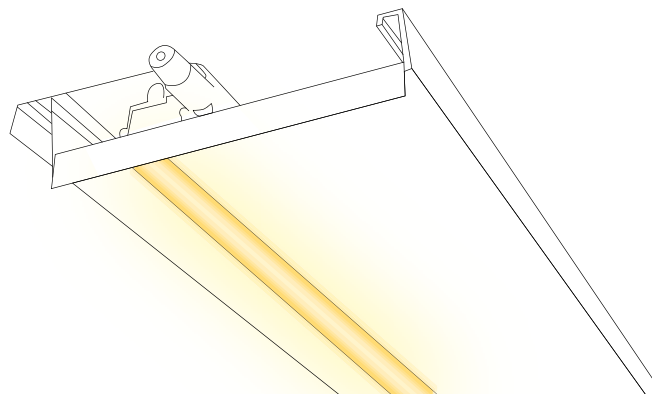
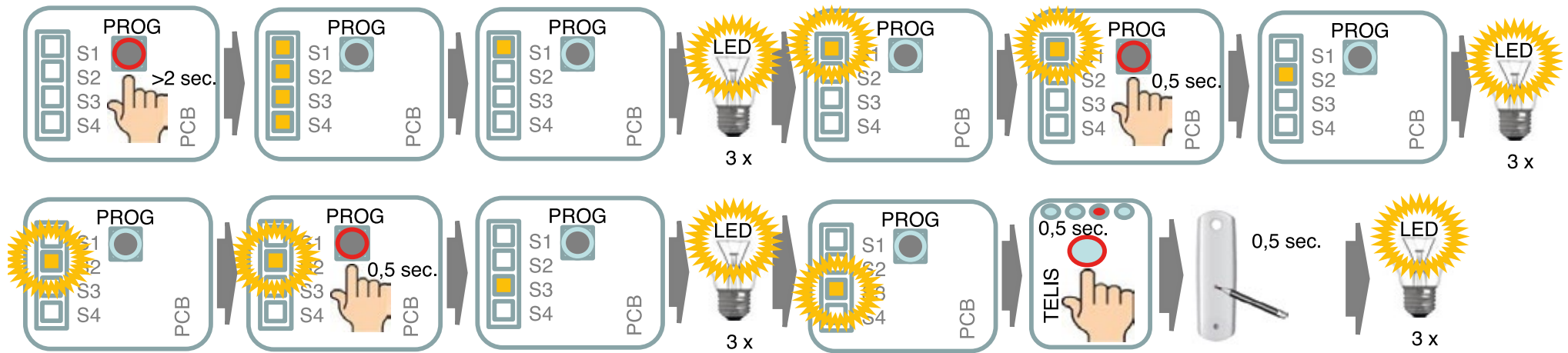
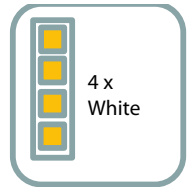

Lineo® LED – Set-up

White

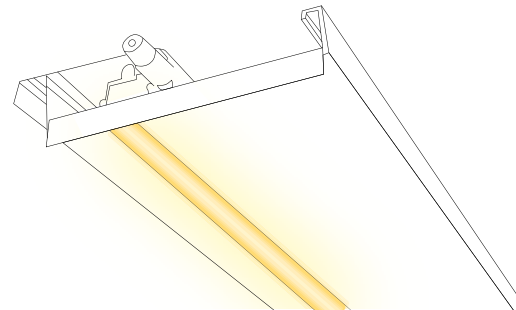
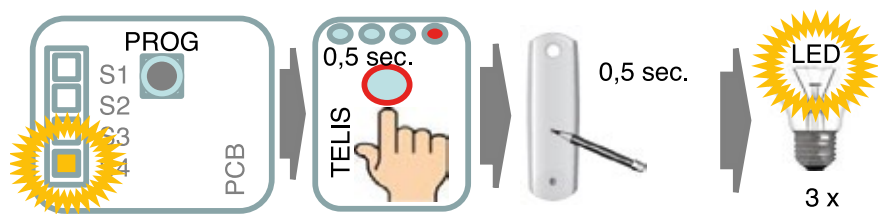
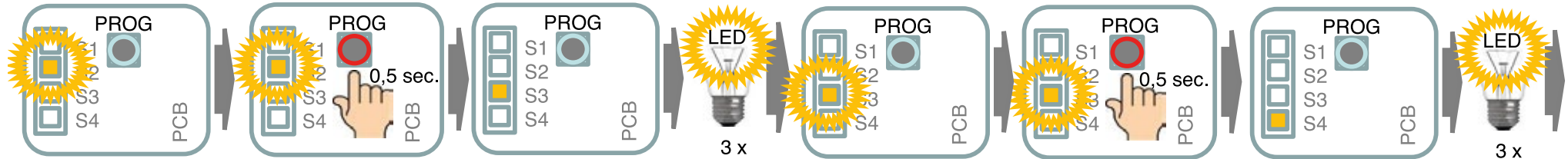
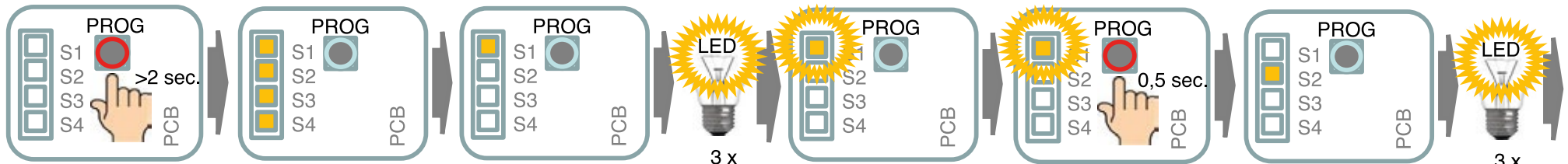

Lineo® LED – Set-up White & RGB

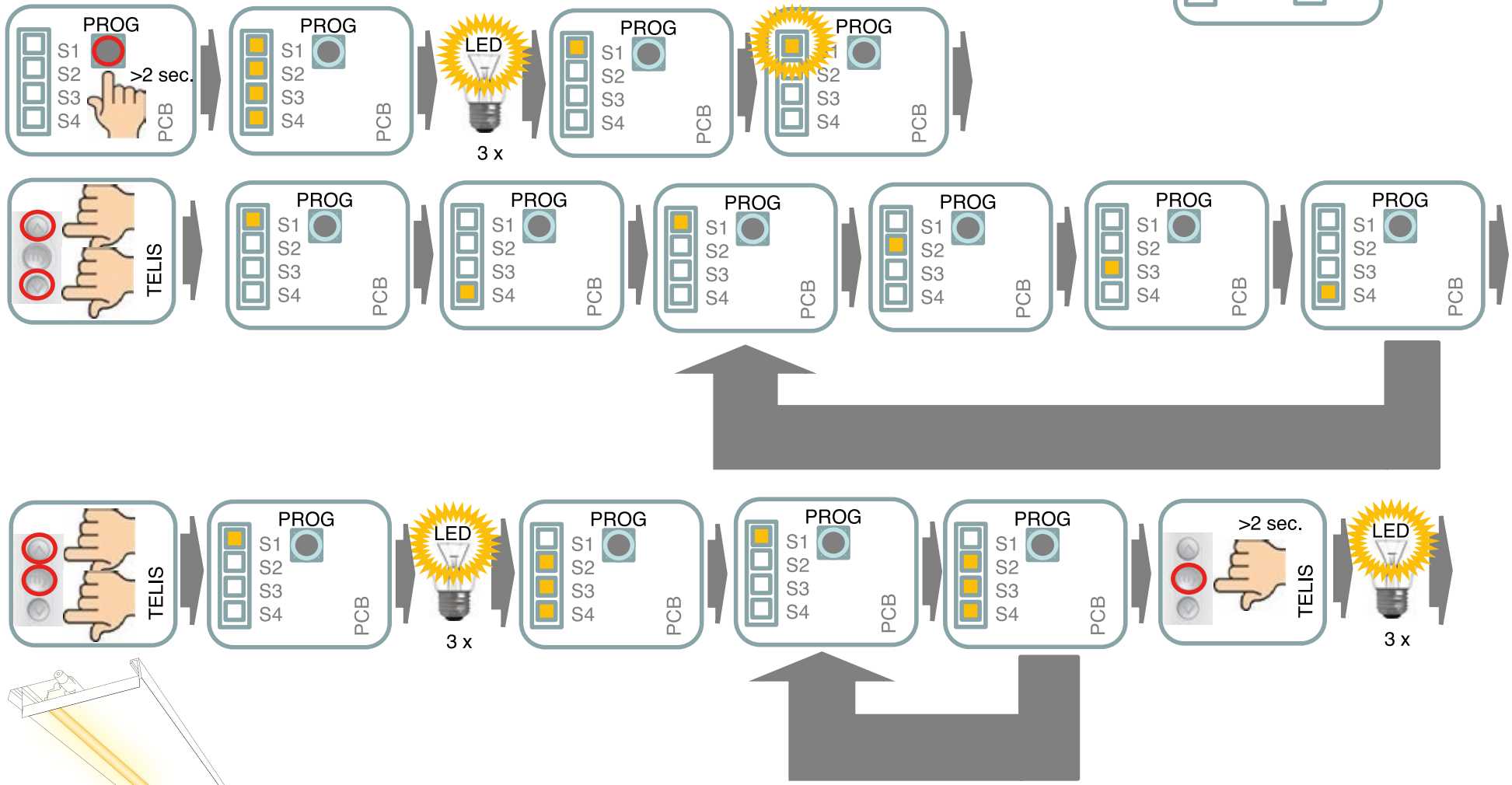
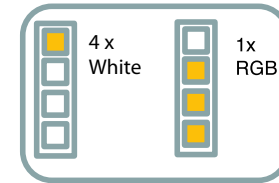
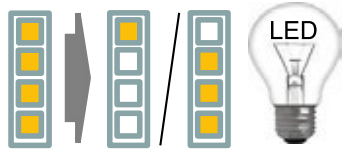

Lineo® LED – Set-up

White & RGB

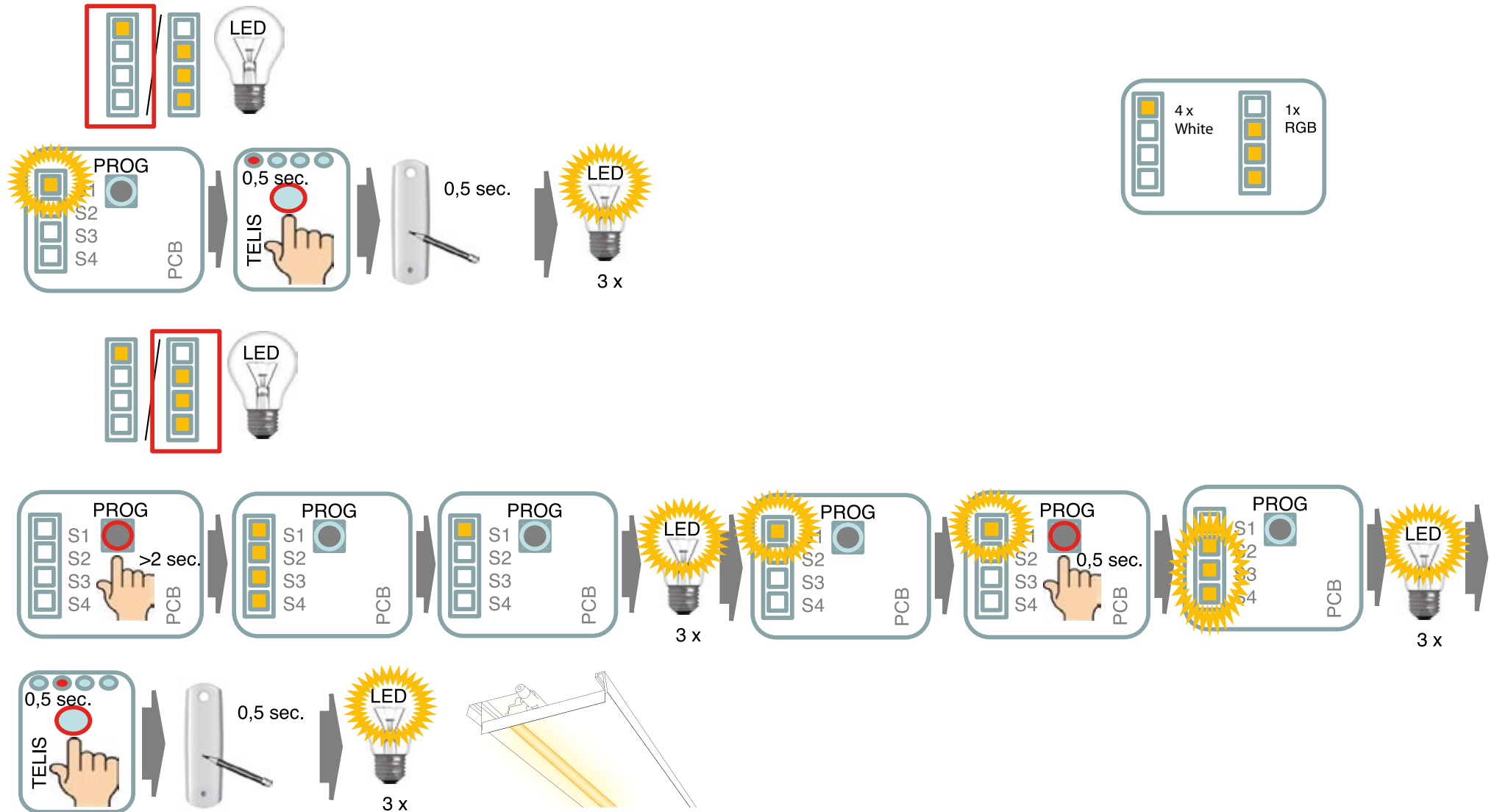

Lineo® LED – Memory reset

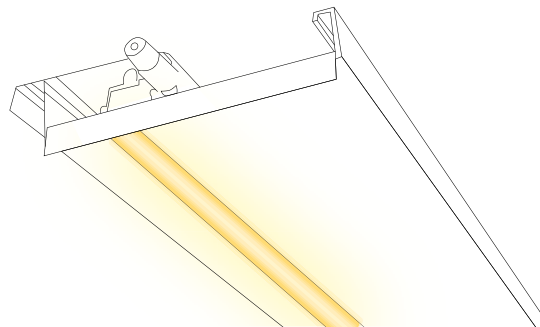
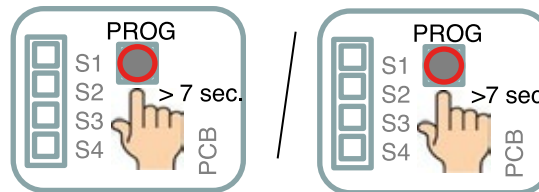

Corradi Srl

Via G. Brini, 39 • 40128 Bologna, Italy

T +39 051 4188 411 • **F** +39 051 4188 400

E info@corradi.eu

www.corradi.eu